

MODEL P5080T REDUCED DEPTH UNIVERSAL TILT MOUNT

FLAT-PANEL TILTING 50"-80" CATEGORY FUNCTION RANGE

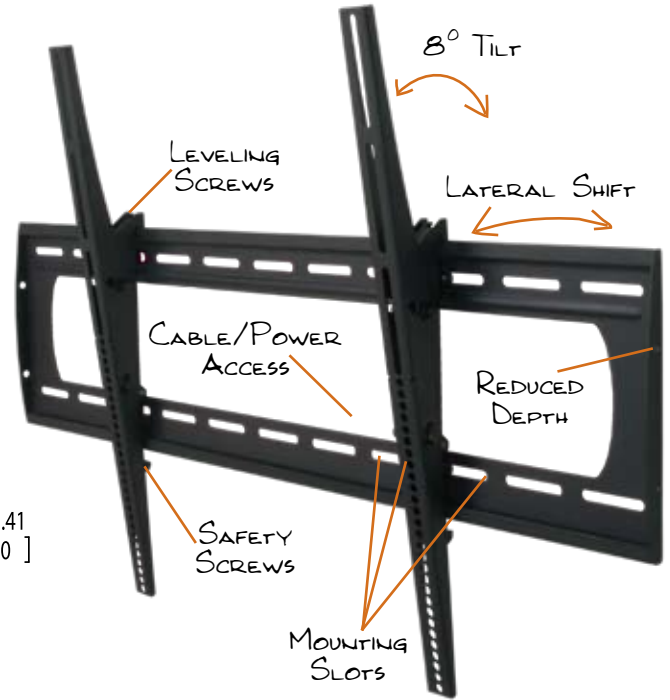
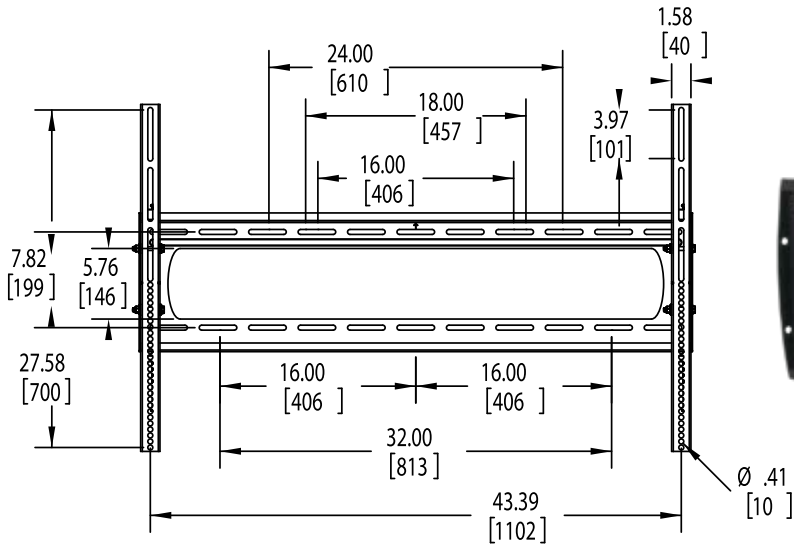

Dimensions in inches and millimeters [mm]
Drawings subject to change without notice

MODELS AND OPTIONAL ACCESSORIES		
MODEL	DESCRIPTION	LIST PRICE
P5080T	Black	\$200.00
GB-INWAVP (Optional)	In-Wall AV Power GearBox™	TBD
PCB-CSL1 (Optional)	Cable Lock	\$50.00

FEATURES	
<ul style="list-style-type: none"> • Rigid reinforced wall plate design • 16", 18", 24" and 32" center mounting slots • Post-mounting display leveling system • Cable and power box access • Safety screws prevent flat-panel removal • Universal hardware pack with patent-pending Universal Spacers • Includes steel stud, concrete & wood fasteners 	

RECOMMENDED APPLICATIONS	
	HOSPITALITY
	HOME
	EDUCATION
	CORPORATE
	RETAIL
	DIGITAL SIGNAGE

SPECIFICATIONS	
DISPLAY SIZE	50"-80"
TILT	8°
DEPTH FROM WALL	1.97" (50mm)
MOUNTING PATTERN	Up to 1100mmx700mm (WxH)
MAX DISPLAY WEIGHT	300 lbs. (136 kgs.)
COLOR	Black

